

# 1-1/2" Metallic Models OEM / Transfer Pumps

## 1-1/2" Metallic Performance Specifications

<b>Ratio:</b>	1:1
<b>Maximum GPM (LPM):</b>	123 (465)
<b>Displacement per cycle</b> Gallons (Liters):	0.617 (2.34)
<b>Air Inlet (Female):</b>	1/2 - 14 N.P.T.
<b>Fluid Inlet:</b>	1-1/2" - 11-1/2 N.P.T.F.-1, Rp1-1/2(1-1/2-11BSP) 1-1/2" A.N.S.I./DIN flange
<b>Fluid Outlet:</b>	1-1/2" - 11-1/2 N.P.T.F.-1, Rp1-1/2(1-1/2-11BSP) 1-1/2" A.N.S.I./DIN flange
<b>Max. operating pressure</b> psi (bar):	120 (8.3)
<b>Suspended solids max. dia.</b> in.(mm):	1/4" (6.4)
<b>Weight</b> lbs (kg):	PX15R-XAX-XXX 37.7 (17.1) PX15R-XCX-XXX 73.2 (33.2) PX15R-XSX-XXX 61.2 (27.8) PX15R-XHX-XXX 86.9 (39.4) <b>Note:</b> add 3.08 lbs (1.4 kg) for aluminum air motor section add 14.39 lbs (6.53 kg) for stainless steel air motor section
<b>Maximum dry suction lift</b> ft(m):	14 (4.2)
<b>Sound Level:</b>	

PSI	Cycles / Min	db(A)
70	50	81.0



## Ordering Menu

<b>PX15</b>	<b>X</b>	-	<b>X</b>	<b>X</b>	<b>X</b>	-	<b>X</b>	<b>X</b>	<b>X</b>
<b>Model Series</b>	<b>Center Section</b>		<b>Connection</b>		<b>Hardware</b>		<b>Seat Material</b>		<b>Diaphragm Material</b>
<b>PD15</b> Standard Pump	<b>A</b> Aluminum		<b>A</b> N.P.T.F.		<b>P</b> Plated Steel		<b>A</b> Santoprene		<b>A</b> Santoprene
<b>PE15</b> Electronic Interface Accessible Pump	<b>R</b> Polypropylene		Thread		<b>S</b> Stainless Steel		<b>C</b> Hytrel		<b>C</b> Hytrel
	<b>S</b> Stainless Steel		<b>B</b> BSP Thread				<b>E</b> Carbon Steel		<b>G</b> Nitrile
			<b>Y</b> 1-1/2" A.N.S.I./DIN Flange (Center)				<b>F</b> Aluminum		<b>M</b> Medical grade Santoprene
			<b>Wetted Parts</b>				<b>G</b> Nitrile		<b>T</b> PTFE/Santoprene
			<b>A</b> Aluminum				<b>H</b> 440 Stainless Steel (Hard)		<b>V</b> Viton
			<b>C</b> Cast Iron				<b>L</b> Hastelloy-C		
			<b>H</b> Hastelloy-C				<b>S</b> 316 Stainless Steel		<b>Ball Material</b>
			<b>S</b> Stainless Steel						<b>A</b> Santoprene
									<b>C</b> Hytrel
									<b>G</b> Nitrile
									<b>S</b> 316 Stainless Steel
									<b>T</b> PTFE
									<b>V</b> Viton

## Accessories\*

### Air Line Connection Kit | Kit No. 66084-1

Kit includes Piggyback Filter/Regulator with gauge, pipe nipple and a 5-foot section of air hose.

### Diaphragm Failure Detection (DFD) | Kit No. 67237

Costly production downtime due to pump diaphragm failure and resulting (possibly hazardous) material leakage is a very real problem in many process operations. ARO Diaphragm Failure Detection is one simple, cost-effective way to get your pumps wired for preventive maintenance. (PE15X pump model is required)

### Cycle Counter Kit | Kit No. 67350

Like the odometer on your car, ARO's cycle sensing / cycle counter lets you know how many pump cycles have elapsed so you can be prepared to perform preventive maintenance. The cycle sensor is a cost-efficient way to save maintenance costs while keeping your pump on-line. (PE15X pump model is required)

**Service Repair Kits |** Kit No. 637389 (air motor for PX15X)  
Kit No. 637375-XX (fluid section)  
Kit No. 637390-X (major air valve assembly)

\*Please note pumps are not included with these kits.



66084-1  
Air Line Connection

# 1-1/2" Metallic Dimensions and Flow Curves OEM / Transfer Pumps

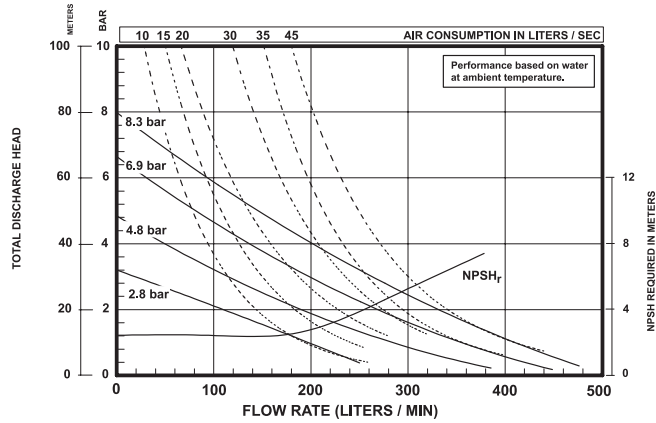
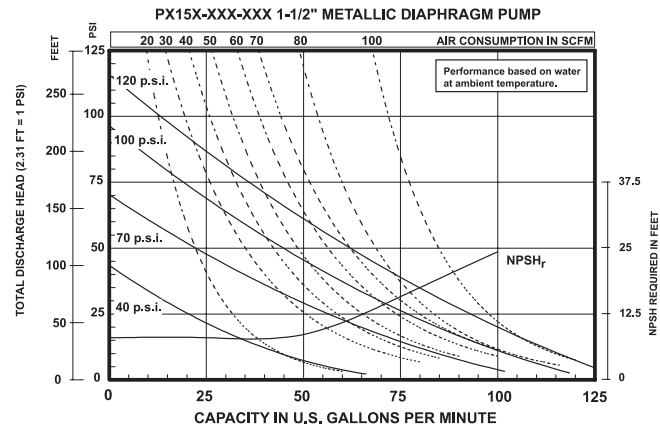
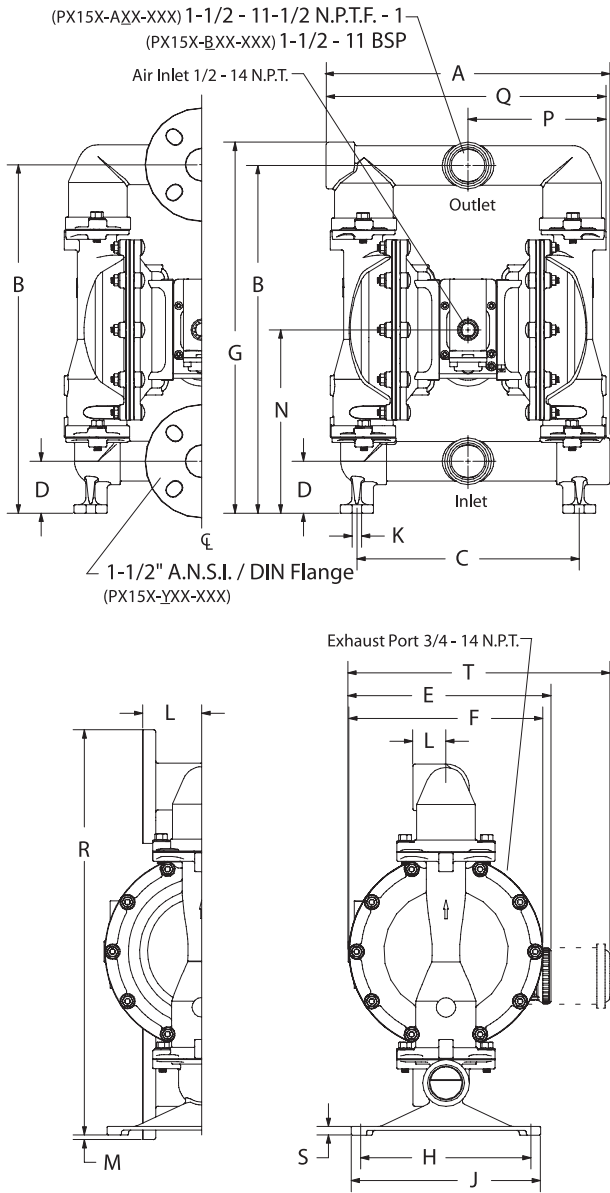

Refer to [www.ingersollrandproducts.com](http://www.ingersollrandproducts.com) for full size flow curves.

For additional information contact technical support at 1.800.483.4981

## DIMENSIONS

A - see below	G - 19-5/8" (498.1 mm)	N - 9-11/16" (246.0 mm)
B - 18-3/8" (466.7 mm)	H - 9" (228.6 mm)	P - see below
C - 11-3/4" (298.5 mm)	J - 10" (254.0 mm)	Q - see below
D - 2-3/4" (69.9 mm)	K - 1/2" (12.7 mm)	R - 21-7/16" (543.9 mm)
E - see below	L - see below	S - see below
F - 10-1/4" (260.4 mm)	M - 1/4" (6.4 mm)	T - see below

	"A"	"L"	"P"	"Q"	"S"
PX15X-XAX-XXX	14-7/8" (377.8 mm)	1-3/4" (44.5 mm)	7-7/32" (183.4 mm)	14-23/32" (373.9 mm)	1/2" (12.7 mm)
PX15X-XCX-XXX	14-5/8" (371.5 mm)	1-3/4" (44.5 mm)	7-3/16" (182.6 mm)	14-1/2" (368.3 mm)	1/4" (6.4 mm)
PX15X-XHX-XXX	14-9/16" (370.0 mm)	3-1/8" (79.4 mm)	7-3/16" (182.6 mm)	14-1/2" (368.3 mm)	1/4" (6.4 mm)
PX15X-ASX-XXX, -BSX	14-25/32" (375.5 mm)	1-3/4" (44.5 mm)	7-9/32" (185.0 mm)	14-13/16" (375.5 mm)	15/32" (11.4 mm)
PX15X-YSX-XXX	14-9/16" (370.0 mm)	3-1/8" (79.4 mm)	7-9/32" (185.0 mm)	14-9/16" (370.0 mm)	15/32" (11.4 mm)

	"E"	"T"
PX15A-XXX-XXX	-----	14-1/32" (356.2 mm)
PX15R-XXX-XXX	11-3/32" (281.3 mm)	-----
PX15S-XXX-XXX	-----	13-27/32" (351.4 mm)

METALLIC